

### PARTS

(1) Hardware

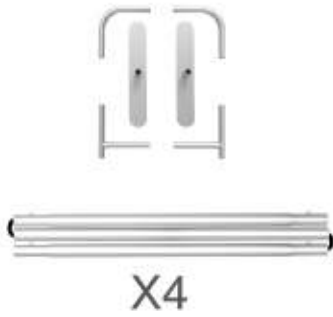

(2) Graphic printing fabric banner



(3) LED Light  
Light Clips



#### STEP 01

To connect the poles according to the labellings

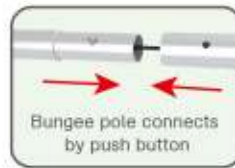
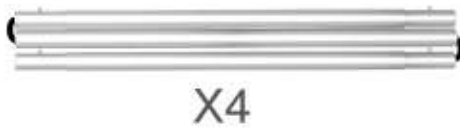

#### STEP 02

Connect the support poles .

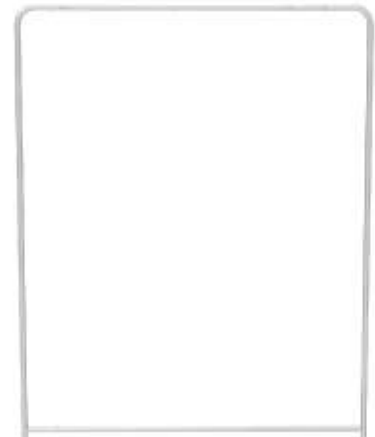
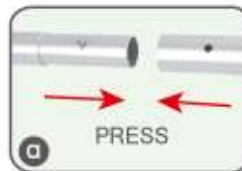
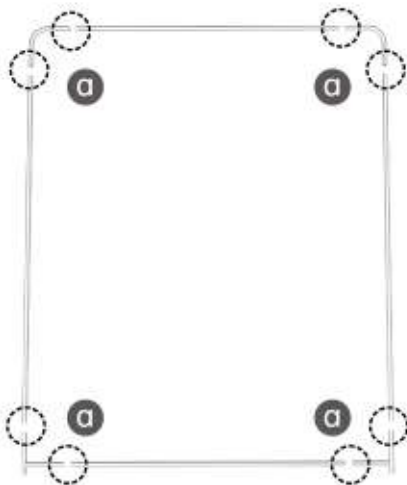

### PARTS

#### STEP 03

To slide the fabric banner on the frame from top and zip up at bottom



#### STEP 04

To assemble the stand feet in position

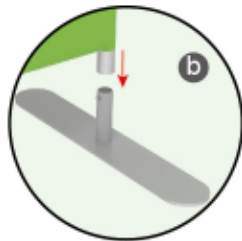
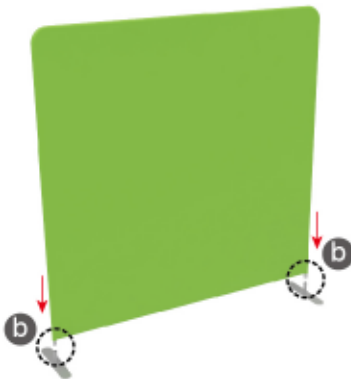

### PARTS

(1) Hardware



(2) Graphic printing fabric banner



(3) Shelves and Bracket x 2



(4) 1x TV rack and screw bag

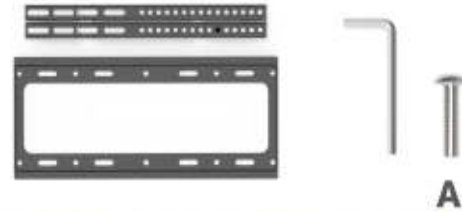

### STEP 01

To connect the poles according to the labellings

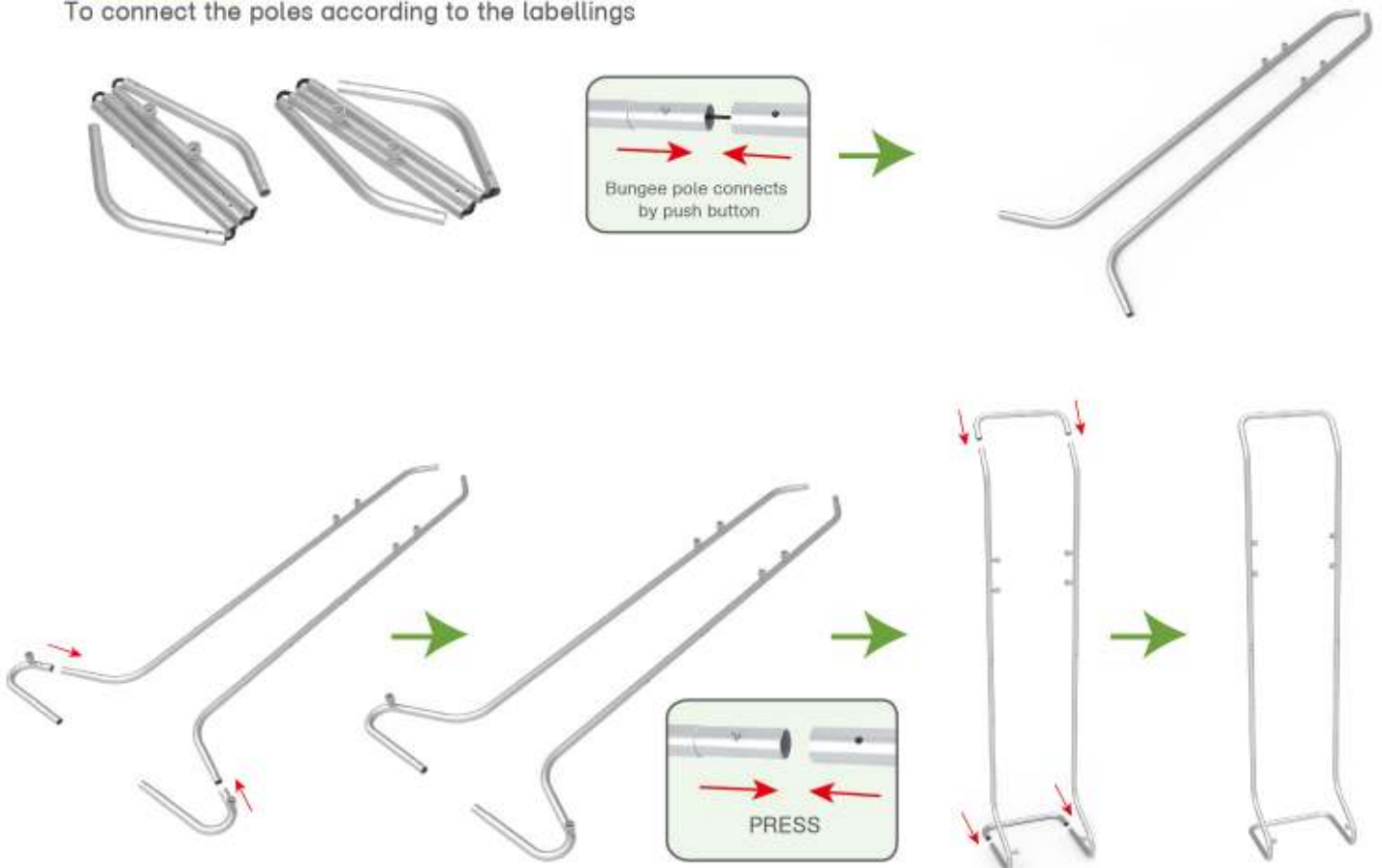

### PARTS

#### STEP 02

To install the cross bar in position

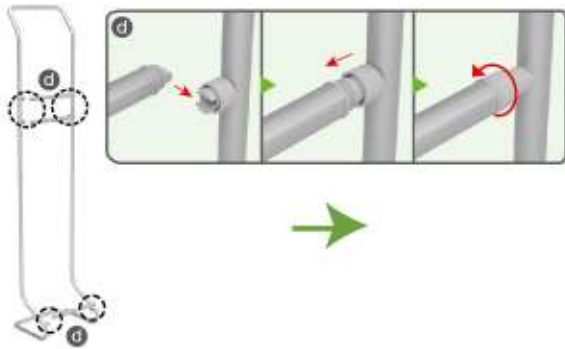

#### STEP 03

To slide over the fabric banner from top to bottom and zip up



#### STEP 04

To install the shelves by using the bracket, afterwards to install the TV mount in position

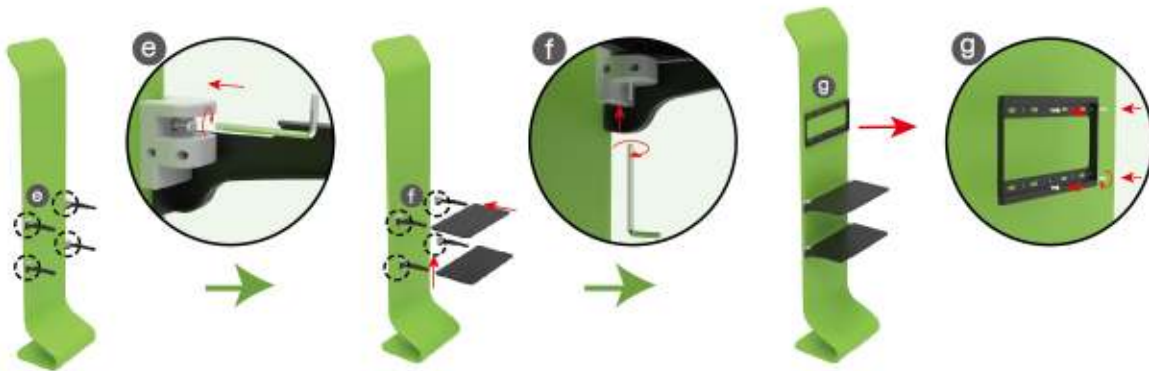

#### STEP 05

To install the TV in position

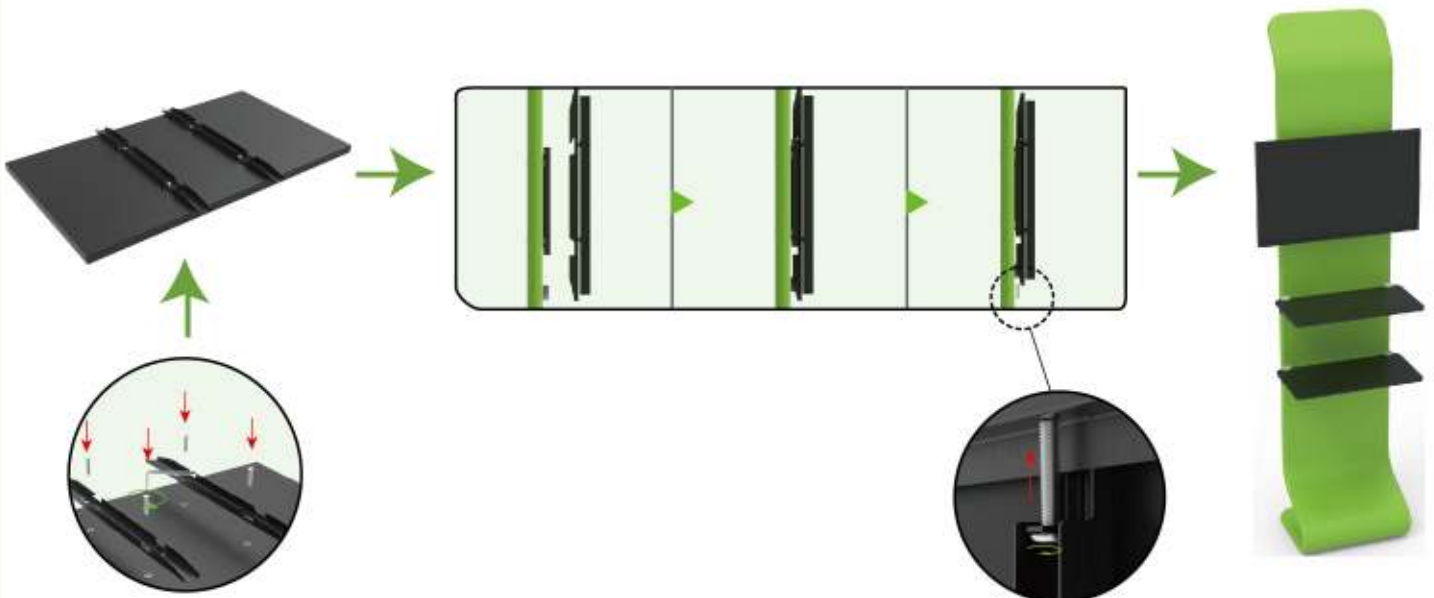

### PARTS

(1) Hardware



(2) Graphic printing fabric banner



#### STEP 01

To connect the poles according to the labellings

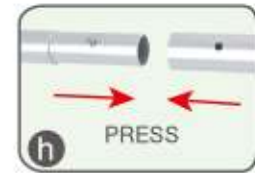
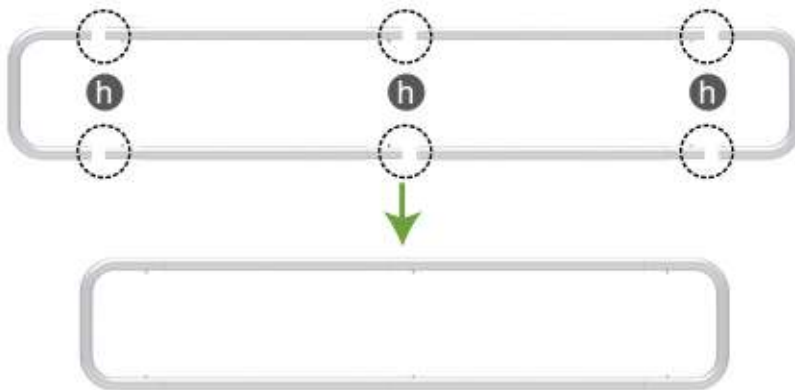

#### STEP 02

To slide the fabric banner on the frame from side and zip up at side

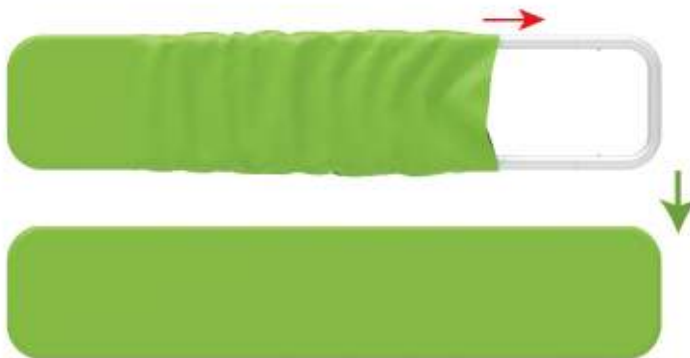

### PARTS

### Booth Set Assembly



(2) 180 degree C Clip. x 2  
90 degree C clip x 2



#### STEP 01

Lie down the back wall and install the TV stand & header by using C clip  
\*\*90 degree C clip for TV stand; 180 degree C clip for header\*\*

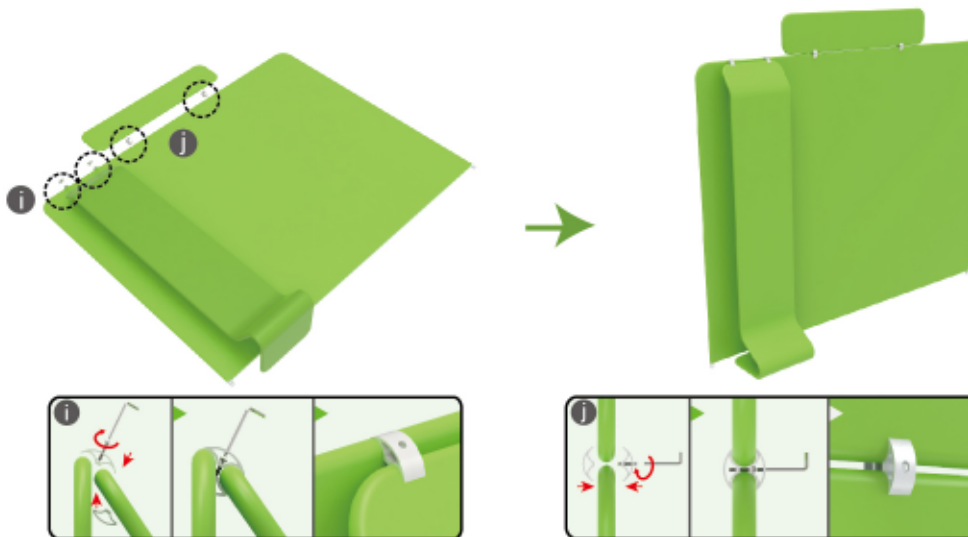

#### STEP 02

To assemble the stand feet in position

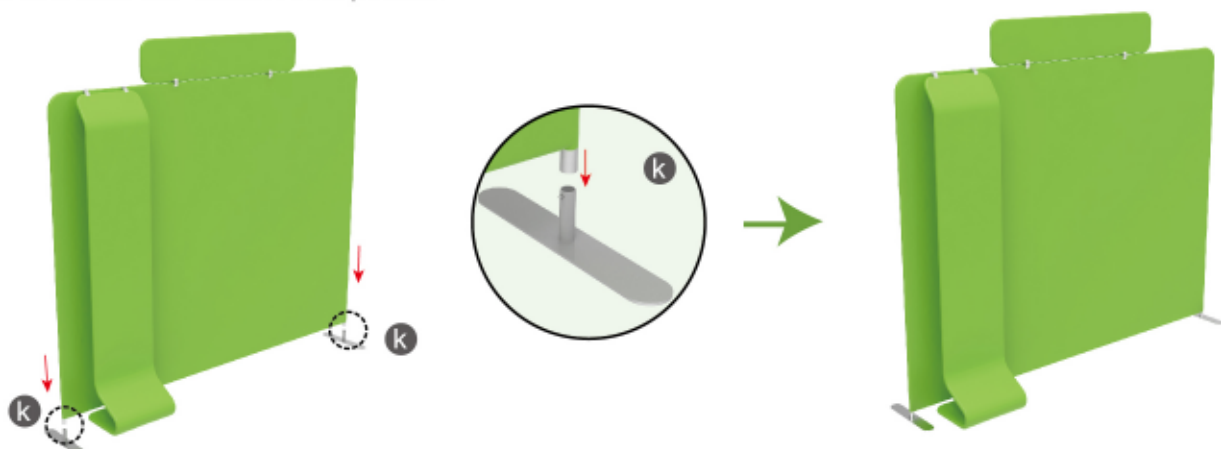

### PARTS

#### STEP 03

To hang TV in position



#### STEP 04

Install LED light

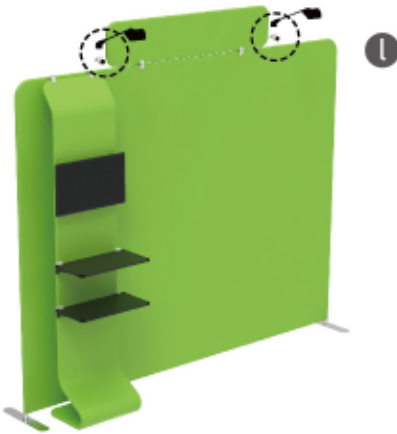

Same assembly steps for 10ft booth-G, W, 17



TF-SB-10X10-17  
10x10FT-BOOTH-F



10x10FT-BOOTH-G  
10x10FT-BOOTH-W