

PARTS

(1) Hardware

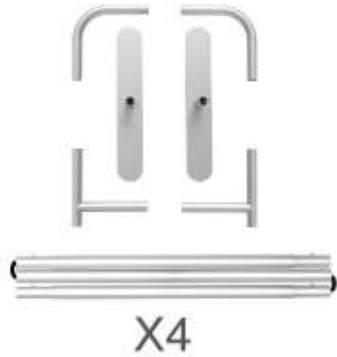

(2) Graphic printing fabric banner



(3) LED Light
Light Clips



STEP 01

To connect the poles according to the labellings

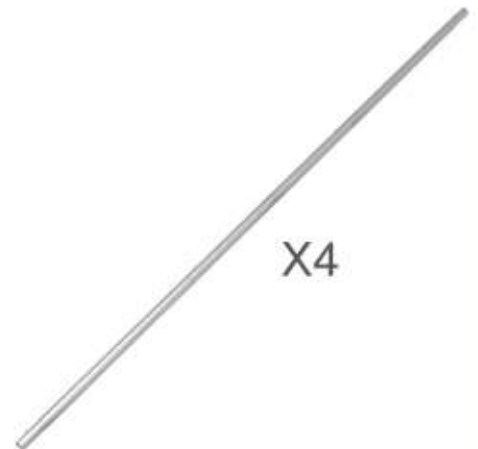
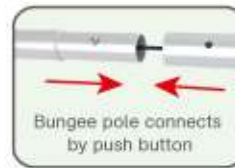
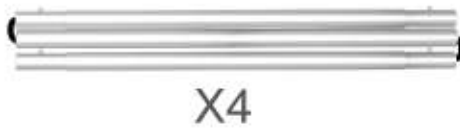

STEP 02

Connect the support poles .

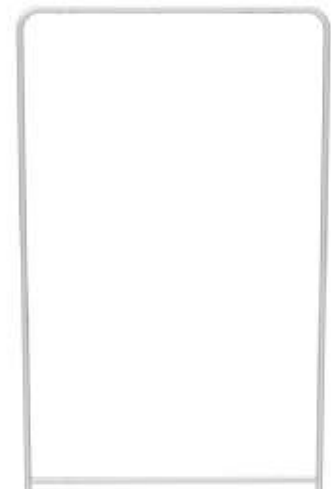
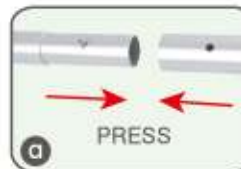
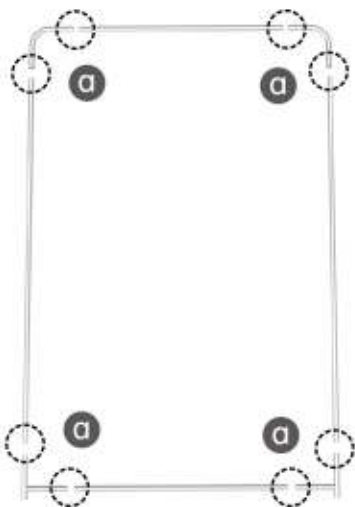

PARTS

STEP 03

To slide the fabric banner on the frame from top and zip up at bottom

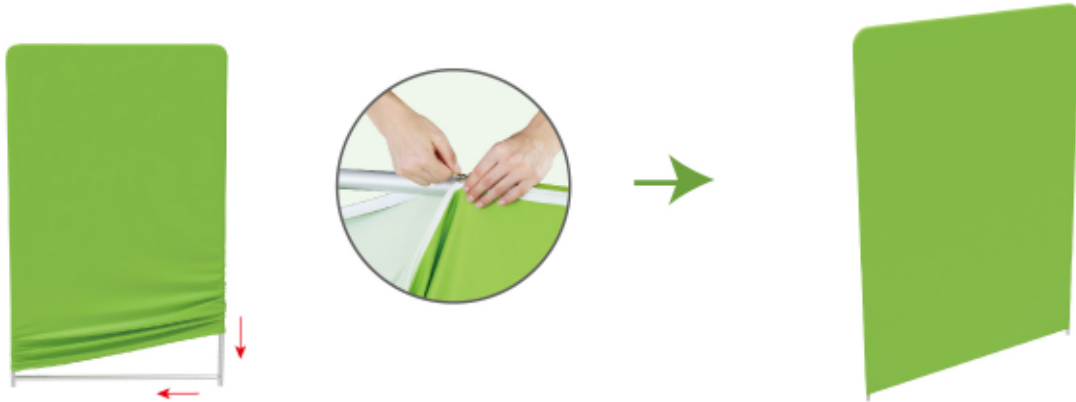

STEP 04

To assemble the stand feet in position

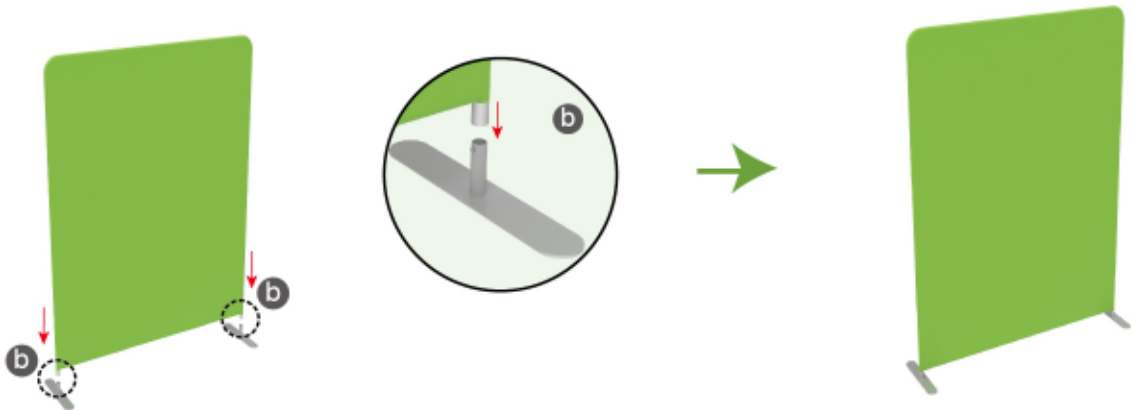

PARTS

(1) Hardware

(2) Graphic printing fabric banner



STEP 01

To connect the poles according to the labellings

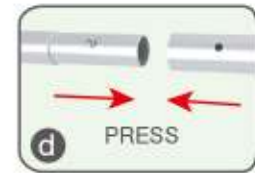
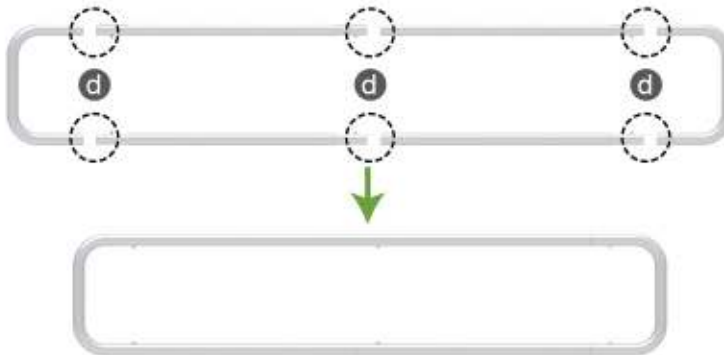

STEP 02

To slide the fabric banner on the frame from side and zip up at side

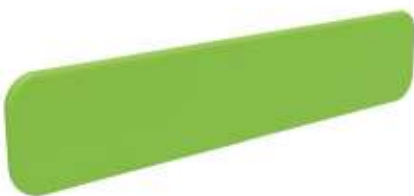
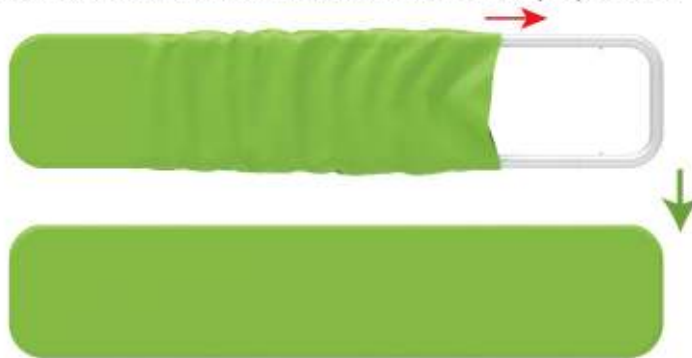

PARTS

STEP 03

To use C clip to connect 2 display stand perfectly

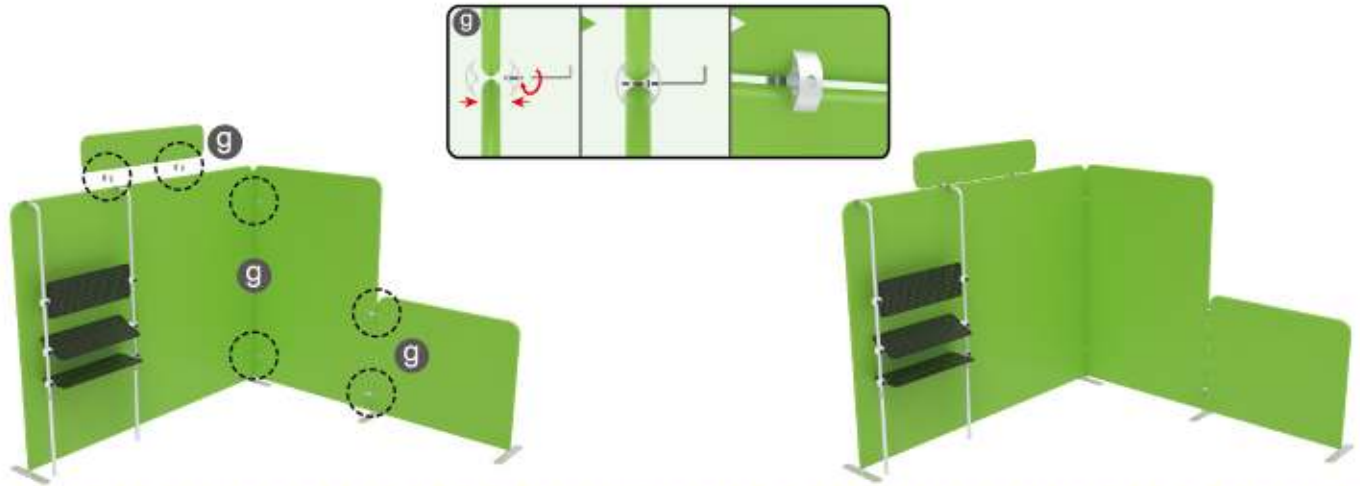

STEP 04

Install LED light

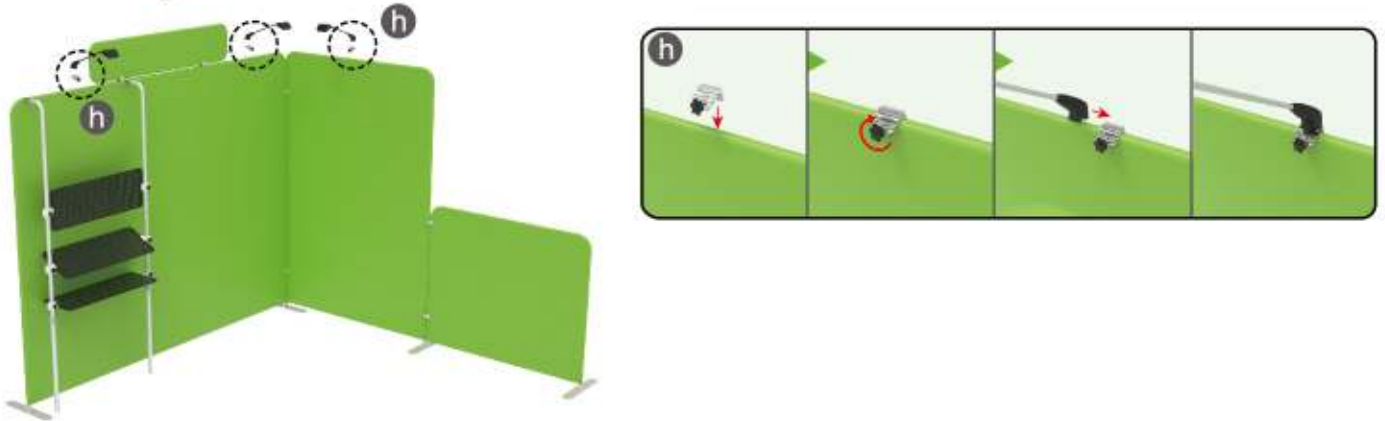

10x10FT-BOOTH-O



10x10FT-BOOTH-Y