

### PARTS

(1) Hardware



(2) Graphic printing fabric banner



(3) LED Light Light Clips



### STEP 01

To connect the poles according to the labellings

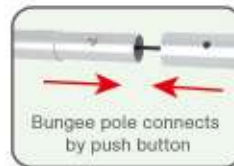
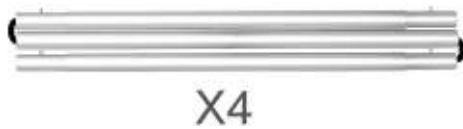

### STEP 02

To use corner pieces to connect the poles to be display stand

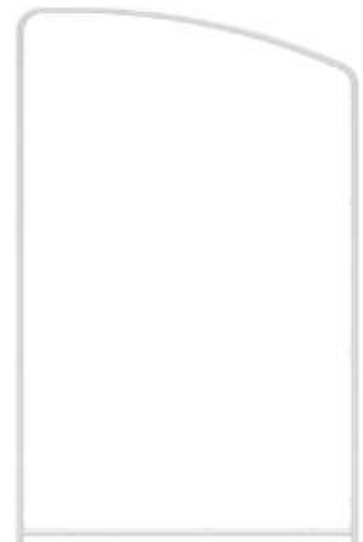
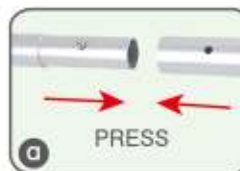
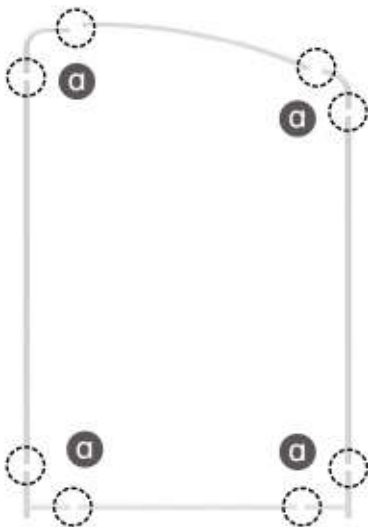

### PARTS

#### STEP 03

To slide the fabric banner on the frame from top and zip up at bottom

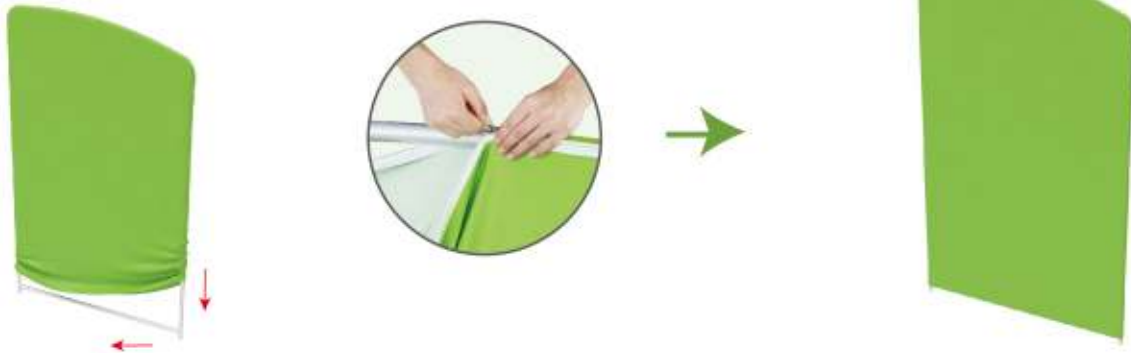

#### STEP 04

To assemble the stand feet in position

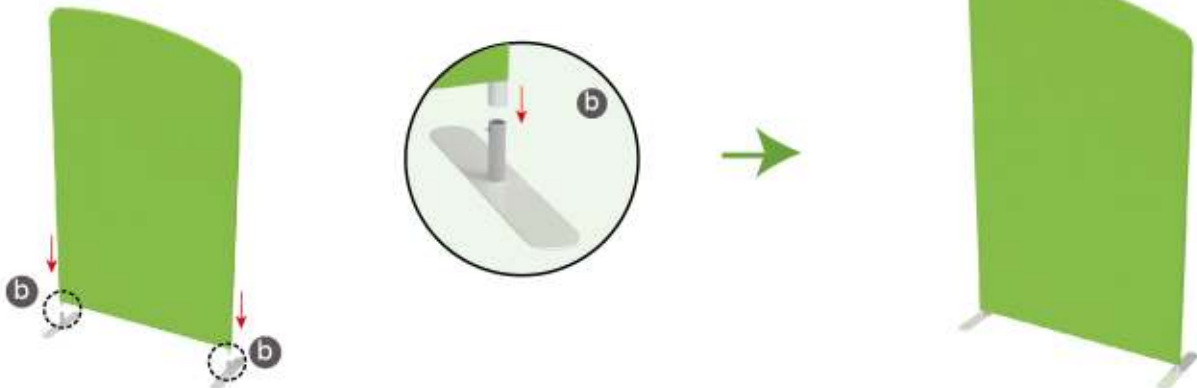

#### STEP 05

Install LED light

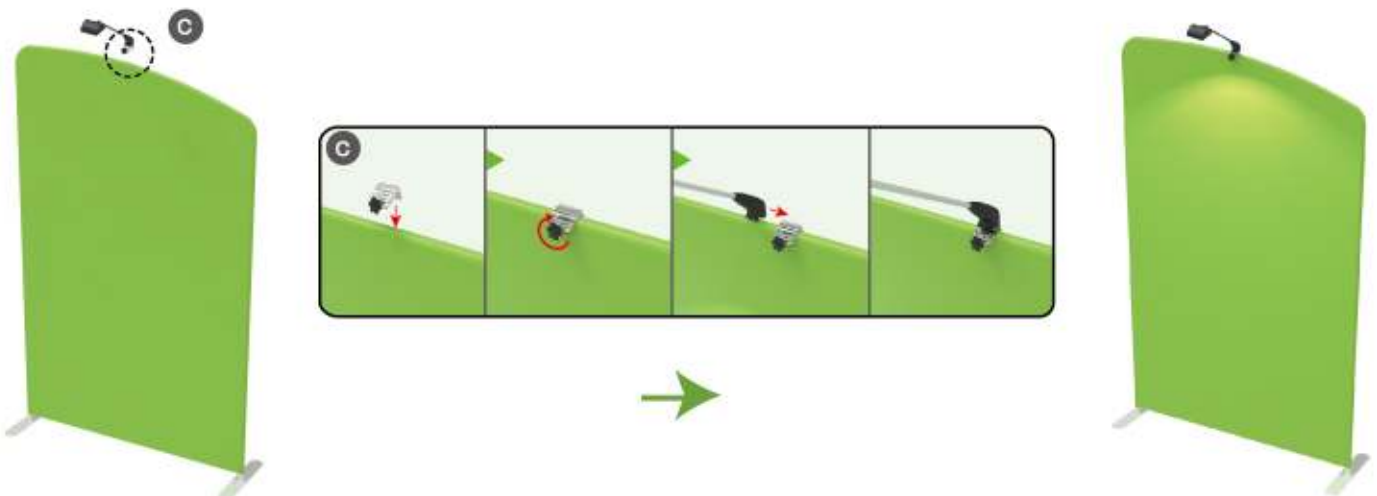

### PARTS

(1) Hardware

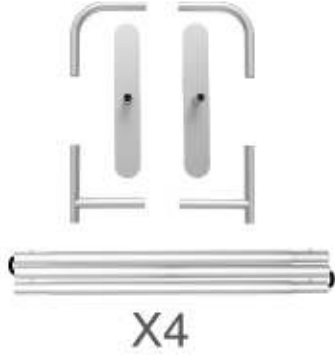

(2) Graphic printing fabric banner



(3) LED Light Light Clips



### STEP 01

To connect the poles according to the labellings

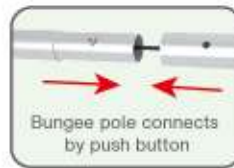
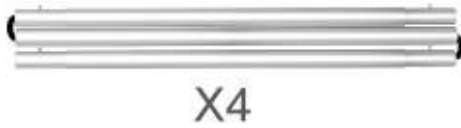

### STEP 02

To use corner pieces to connect the poles to be display stand

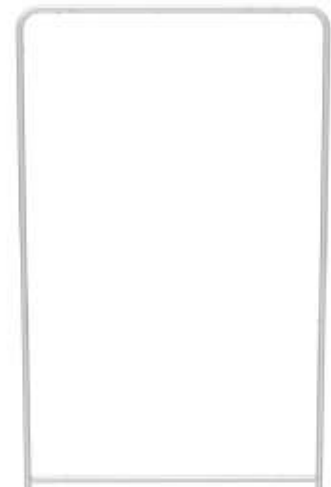
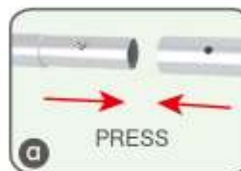
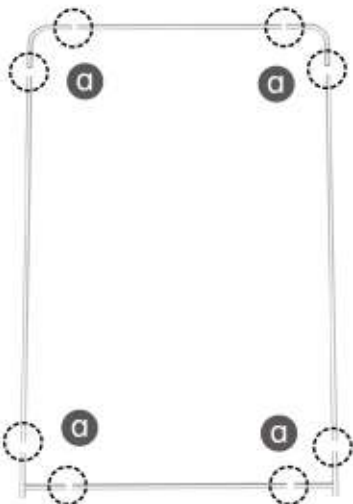

### PARTS

#### STEP 03

To slide the fabric banner on the frame from top and zip up at bottom

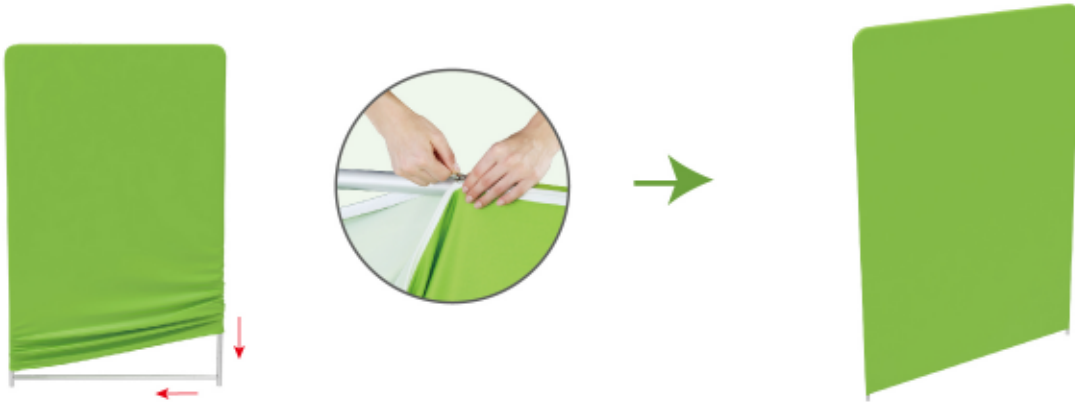

#### STEP 04

To assemble the stand feet in position

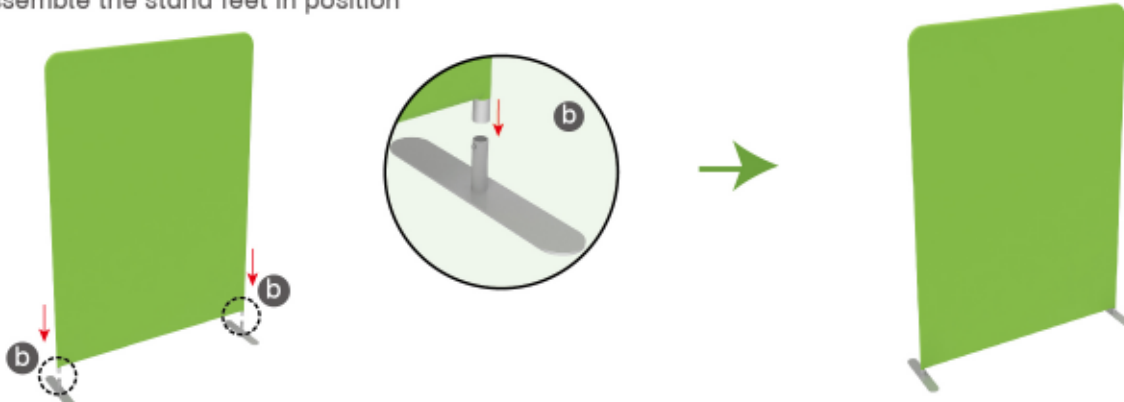

#### STEP 05

Install LED light

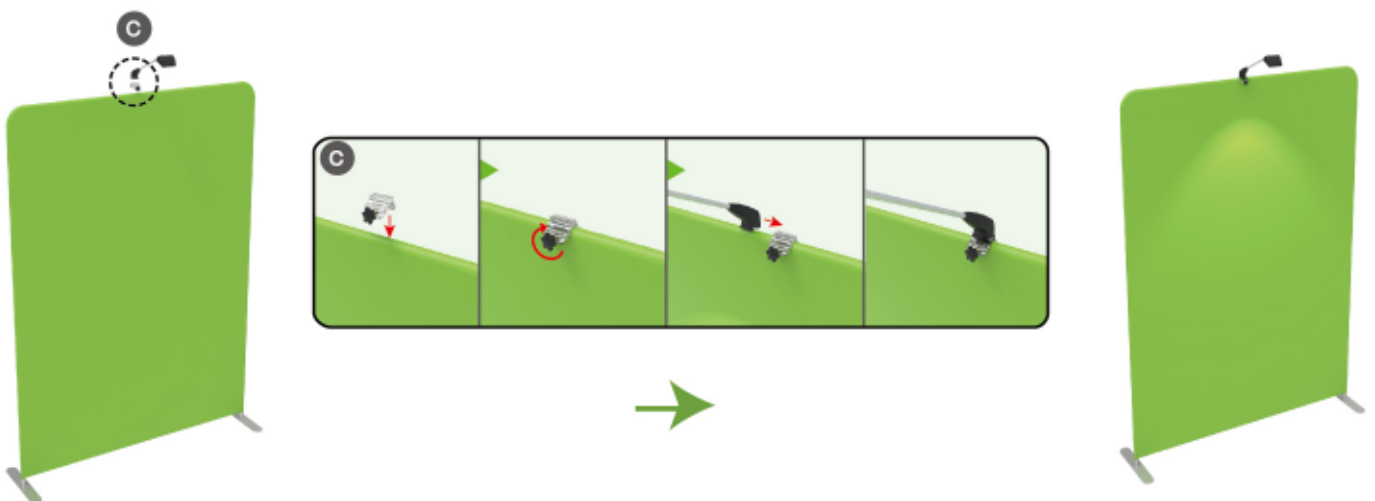

### PARTS

(1) Booth Set

C clip x 2  
Clamp x 1

1x shelf  
1x Upright pole  
for shelf

1x TV mount and screw bag  
1x Allen Key

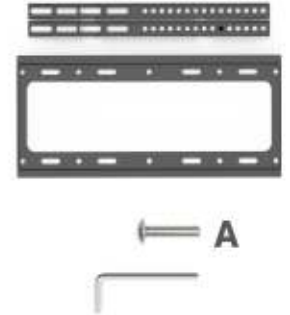

#### STEP 01

To assemble the stand feet in position

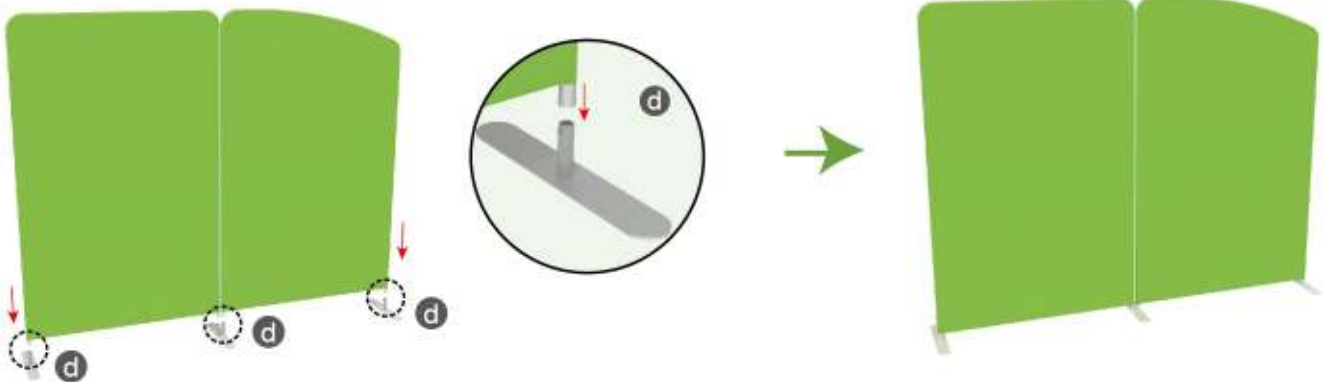

#### STEP 02

To use C clip to connect 2 display stand perfectly

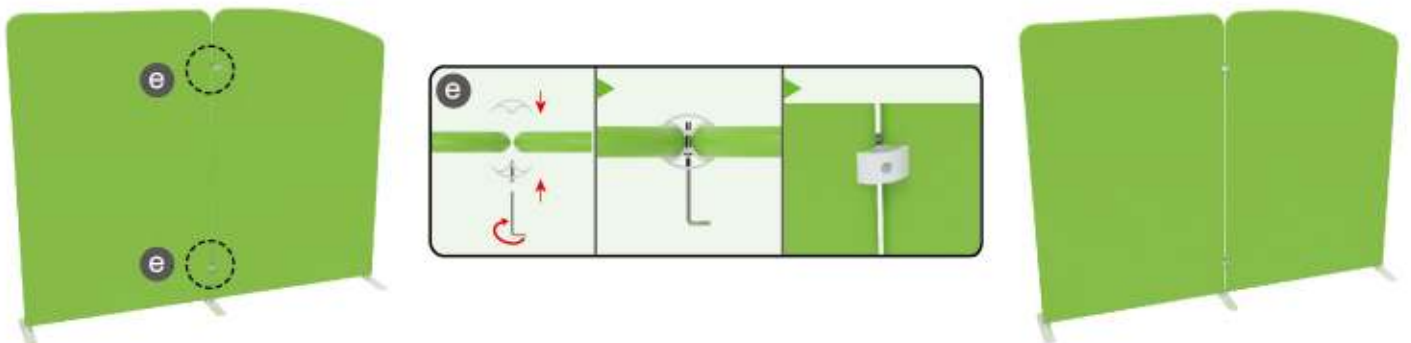



### PARTS

#### STEP 03

To install the shelf in position

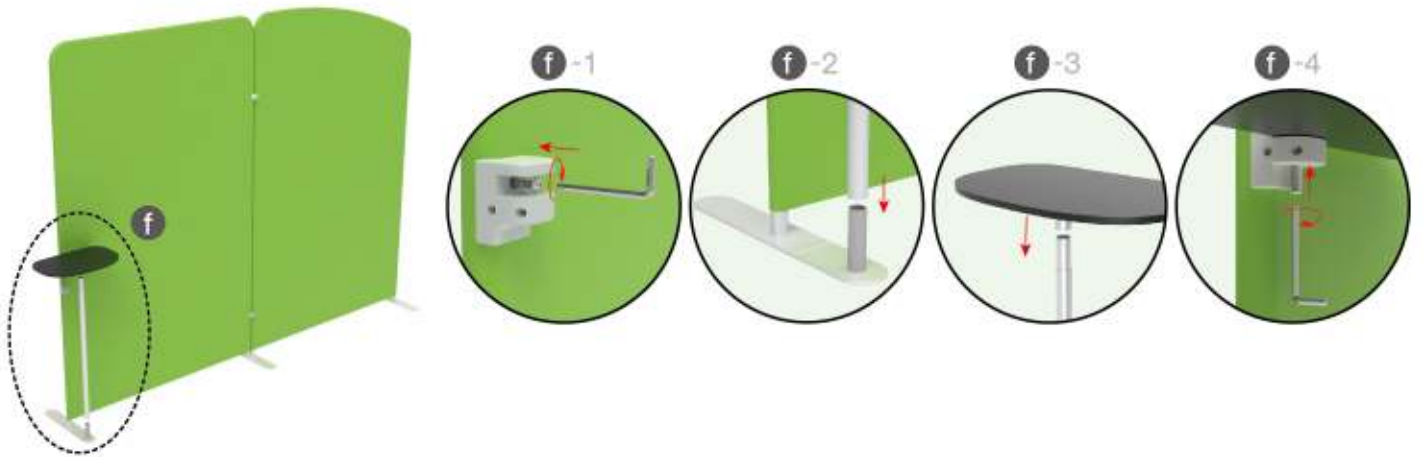

#### STEP 04

To install the TV mount in position

