

PARTS

(1) Hardware

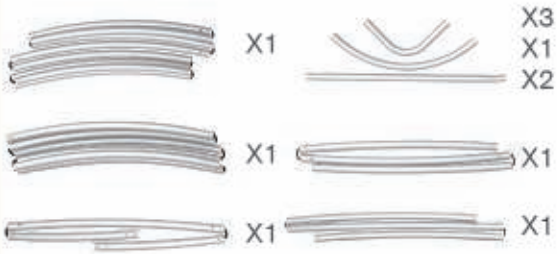

(2) Fabric cover



(3) Screw bag



STEP 01

To connect the poles according to the labellings

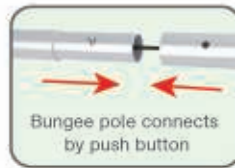

PARTS

STEP 02

To use corner pieces to connect the poles to be display stand

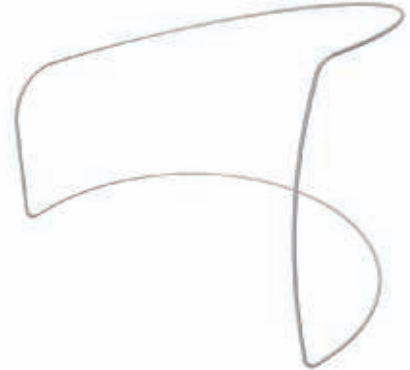
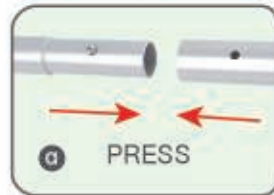
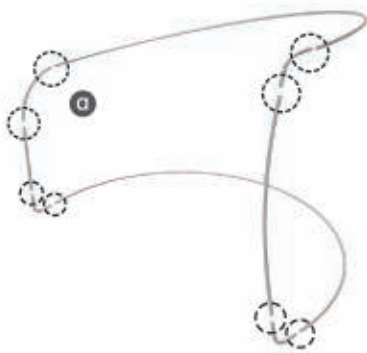

STEP 03

To use Allen Key and follow the labellings to install the upright pole in position

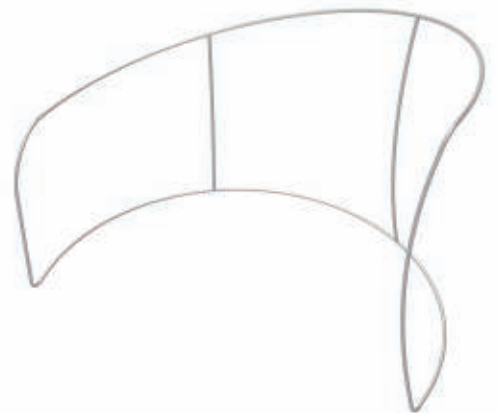
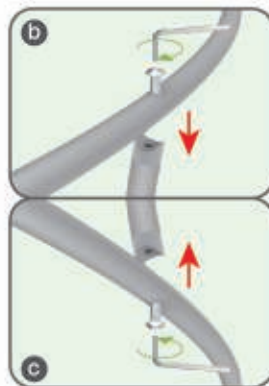
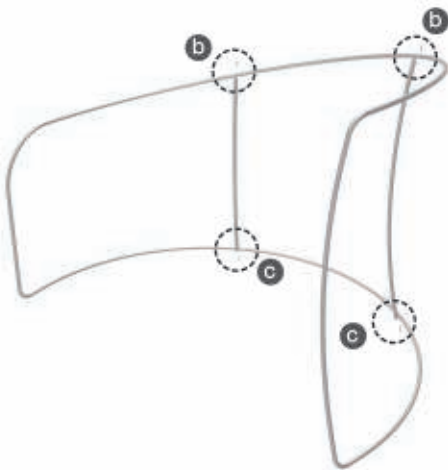

STEP 04

To slide the fabric banner on the frame from bottom and zip up at top

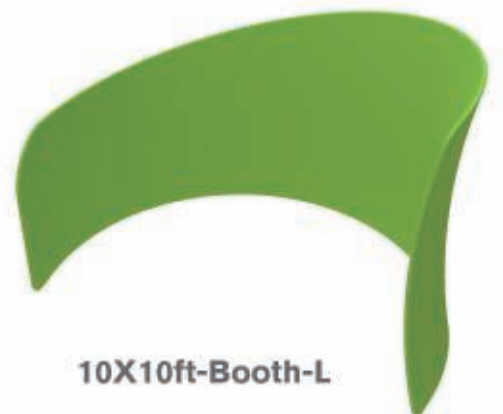
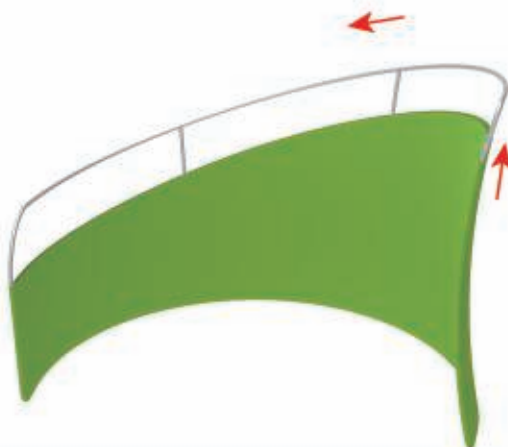

10X10ft-Booth-L

PARTS

Same Assembly Steps for below Booths



10X10ft-Booth-K



10X10ft-Booth-09